



The dramatic entryway at Una is marked by a curvilinear double-height porte cochère.

DESIGN

From a distance, the iconic tower is recognizable by the smooth, light-metallic surface and striking silhouette that recalls the natural shape of a wave. Once inside, residents are met with stunning views of Biscayne Bay at every turn. Floor-to-ceiling windows welcome daylight into each open-plan space, while extra wide terraces are carefully integrated into the great rooms and bedrooms. The result is a seamless transition between inside and outside, celebrating the pleasures of life on the bay.



Floor-to-ceiling windows in main living areas enhance the breathtaking bayfront views.



The level of craftsmanship in the lobby is instantly breathtaking, with wood and precious detailing permeating the 20-foot-high space and a long bank of windows framing the sparkling views of the bay.



Sleek and spa-like, the master bathrooms feature a material mix of natural stone selections, stained wood and porcelain tile, creating an atmosphere of peace and relaxation.



The sublime views of Biscayne Bay and beyond can be enjoyed to the fullest on the 10-foot-deep terraces.

RESIDENCE TYPES

2 RESIDENCES
LEVELS 38 – 43
4 Bedrooms, 6.5 Baths, Den
4,697 SQ FT / 4,786 SQ FT

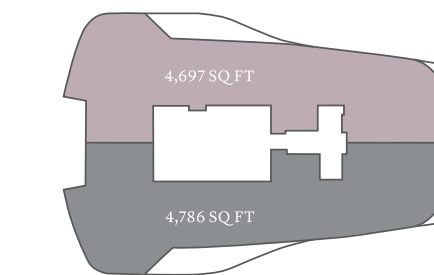

Biscayne Bay

4 RESIDENCES
LEVELS 19 – 37
FLOORS 19 – 29
3 Bedrooms, 3.5 Baths
1,915 SQ FT / 1,995 SQ FT

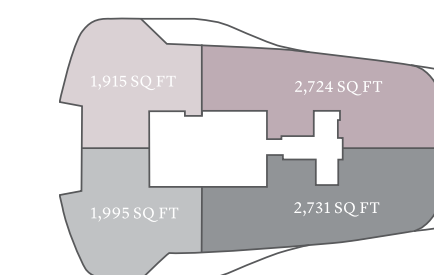

Biscayne Bay

FLOORS 30 – 37
3 Bedrooms, 3.5 Baths
1,939 SQ FT / 2,019 SQ FT

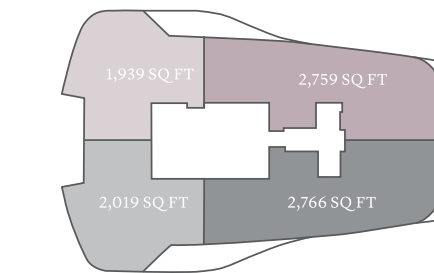

Biscayne Bay

1 RESIDENCE
LEVELS 17 – 18
4 Bedrooms, 4.5 Baths
4,222 SQ FT

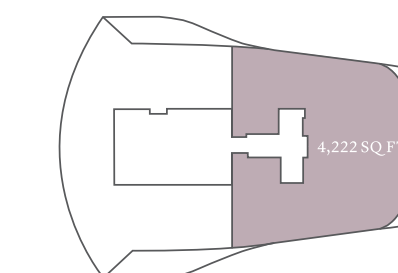

4 RESIDENCES
LEVELS 5 – 16
2 Bedrooms, 2 Baths
1,098 SQ FT / 1,179 SQ FT

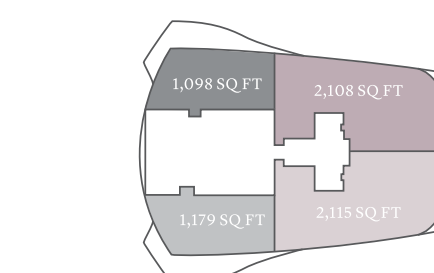

Biscayne Bay

VISION

Designed by Adrian Smith + Gordon Gill Architecture, Una takes inspiration from the elegant shapes and materials of classic yacht design. Instantly recognizable by the sweeping curve of the building's dramatic silhouette, the residences' glass surfaces brilliantly reflect the dazzling sunlight, and floor-to-ceiling windows take advantage of a coveted setting on Biscayne Bay. Una's striking architecture is complemented by lush gardens designed by Enzo Enea, an extensive amenities program, and private boat slips. With easy access to Coconut Grove, Downtown, Brickell, Miami International Airport, and the beaches of Key Biscayne, Una is an exemplar for Miami living.